

## DISASSEMBLY

### 1. REMOVE A/C CONTROL PANEL

- Remove the 3 knobs and 2 switch.
- Remove the A/C control panel.

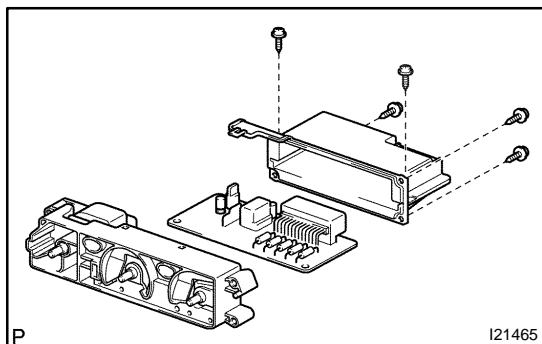

### 2. REMOVE A/C AMPLIFIER

- Remove the 5 screws.
- Remove the A/C control panel case and amplifier.

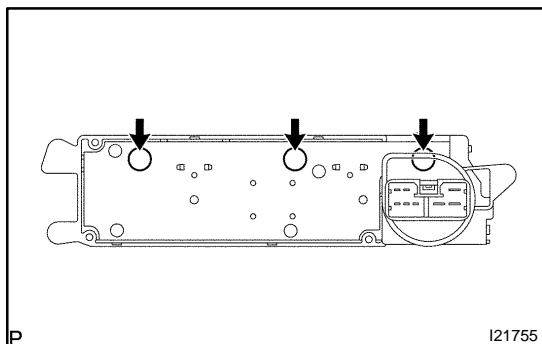

### 3. REMOVE BULB

Using a screwdriver, turn the bulb to the left and pull out the bulb.